



moda

Be My Neighbor

Block 5

12" x 18" finished

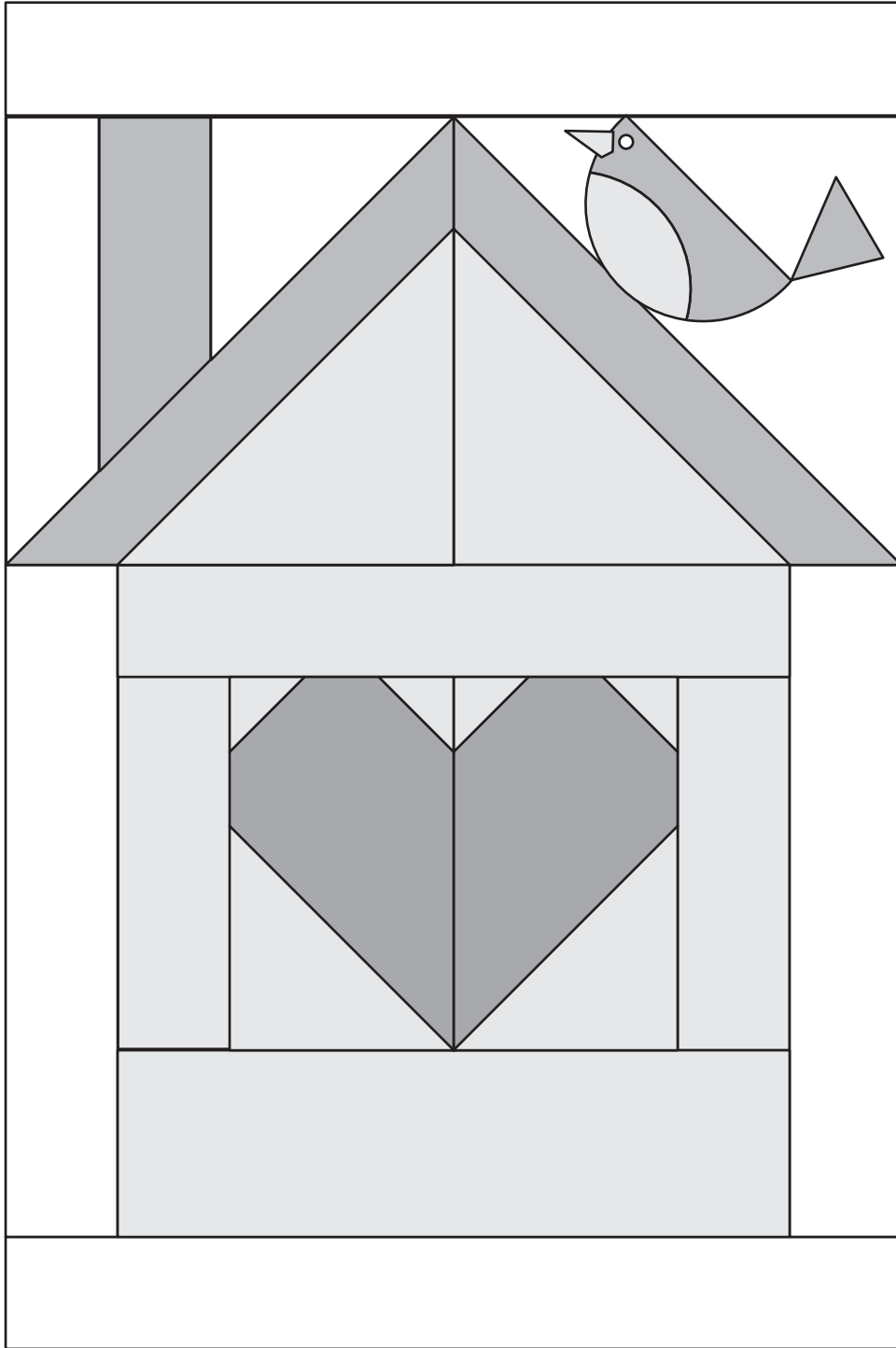

General information

- These are very scrappy blocks. Mix your favorite Moda prints to create your colorful neighborhood!
- Share your progress and final quilt at #BeMyNeighbor. We love to see your results!!!

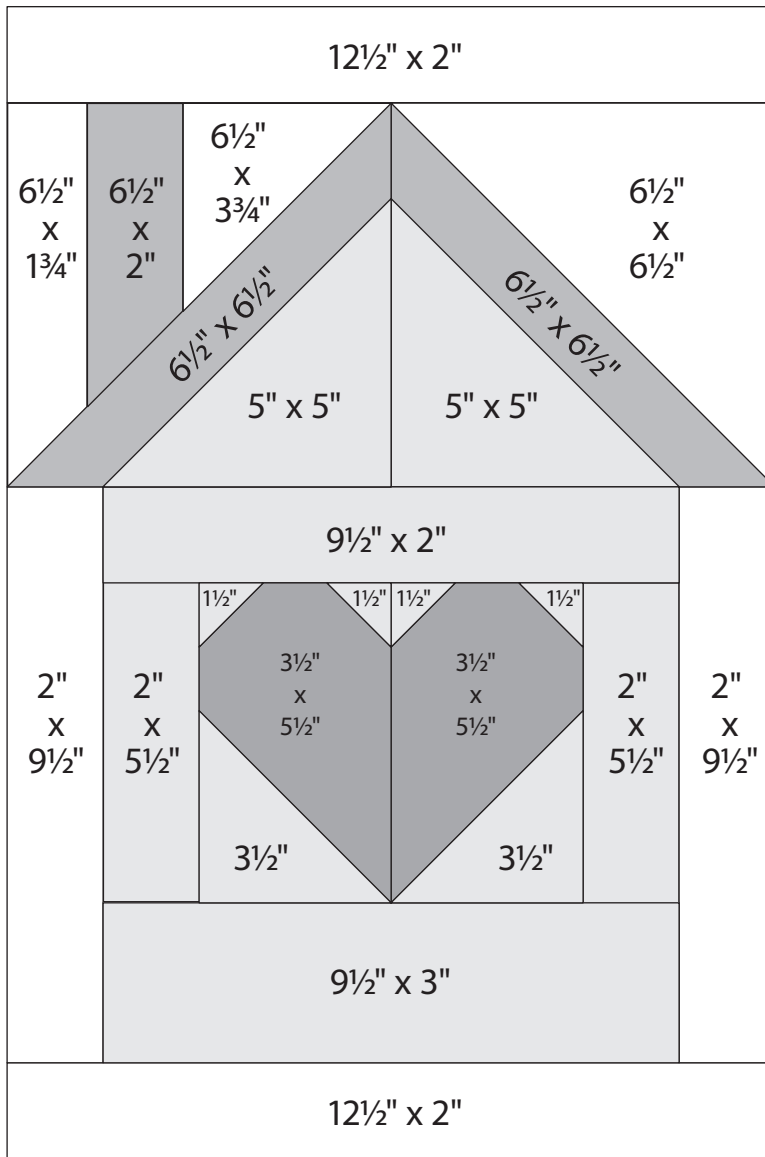

Block 5
12 1/2" x 18 1/2" unfinished

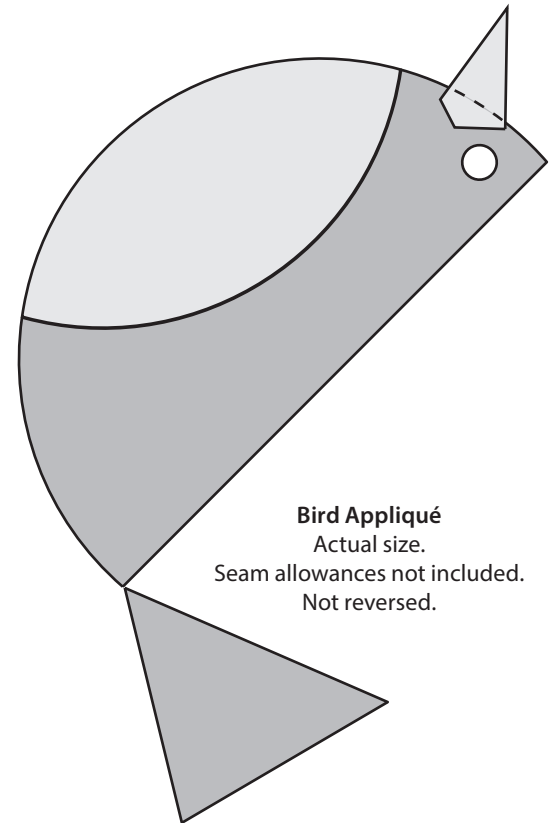

Bird Appliqué
Actual size.
Seam allowances not included.
Not reversed.

Cutting

House

- 1-9 1/2" x 3" rectangles
- 1-9 1/2" x 2" rectangles
- 2-5 1/2" x 2" rectangles
- 2-5" squares
- 2-3 1/2" squares
- 4-1 1/2" squares

Roof: 2-6 1/2" squares

Chimney: 1-2" x 6 1/2"

Heart: 2-3 1/2" x 5 1/2"

Background

- 1-6 1/2" square
- 1-6 1/2" x 3 3/4" rectangle
- 1-6 1/2" x 1 3/4" rectangle
- 2-2" x 12 1/2" rectangles
- 2-2" x 9 1/2" rectangles

Bird Appliqué

- 1-beak
- 1-body
- 1-tail
- 1-wing
- 1-eye



moda Be My Neighbor

Block 5 is 12" x 18" finished.

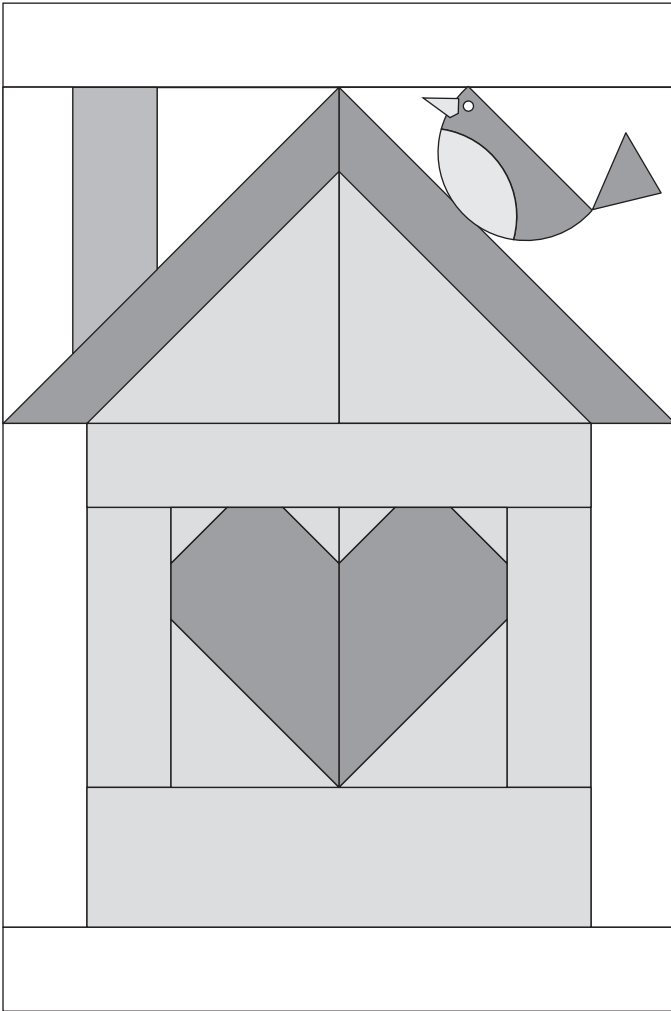

Construction

Use $\frac{1}{4}$ " seams. Press in the direction of the arrows in the diagrams.

1 Roof

- (A) Join a $1\frac{3}{4}$ " x $6\frac{1}{2}$ " background, 2" x $6\frac{1}{2}$ " chimney, and $3\frac{3}{4}$ " x $6\frac{1}{2}$ " background strip as shown.

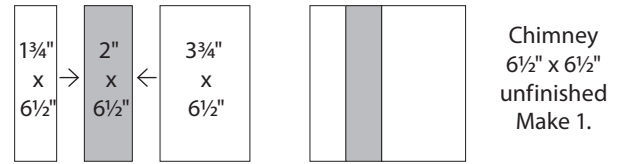

- (B) Draw a diagonal line from corner to corner on the wrong side of 2–5" house squares. Layer a 5" marked background square, right sides to together, on 1– $6\frac{1}{2}$ " roof square as shown. Sew on the diagonal line. Trim $\frac{1}{4}$ " from the sewn line. Press to reveal the triangle. Make 2.

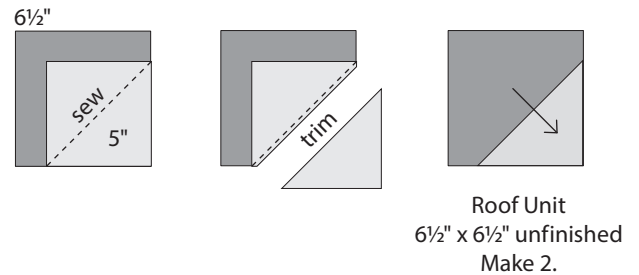

- (C) Draw a diagonal line from corner to corner on the wrong side of the chimney as shown. Layer the marked chimney, right sides together, on a roof unit as shown. Sew, trim, and press. Make 1.

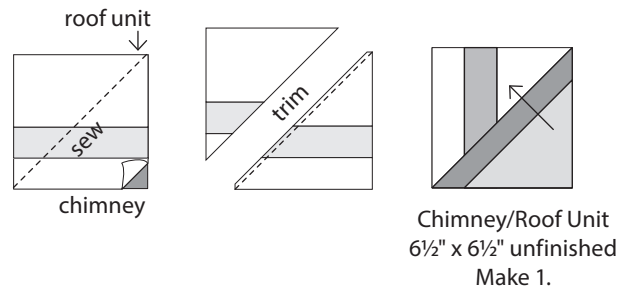

moda

1) Draw a diagonal line from corner to corner on the wrong side of a 6½" background square. Layer the marked square, right sides together, on a roof unit as shown. Sew, trim, and press to reveal the triangle. Make 1. Join units to make the roof.

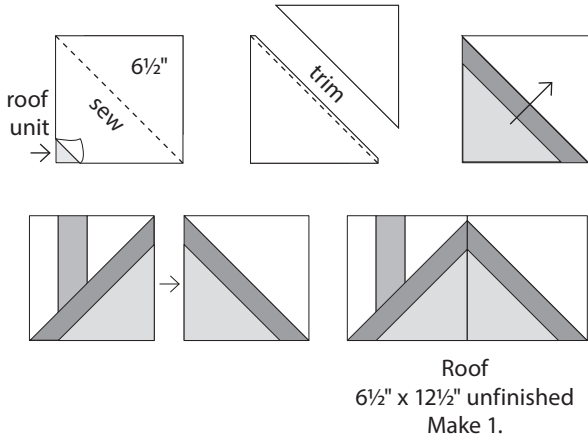

2 Heart Draw a diagonal line from corner to corner on the wrong side of 2–3½" house squares, and 4–1½" house squares. Layer, sew, trim, and press as shown on 2–3½" x 5½" hearts. Join the 2 sides to make the heart.

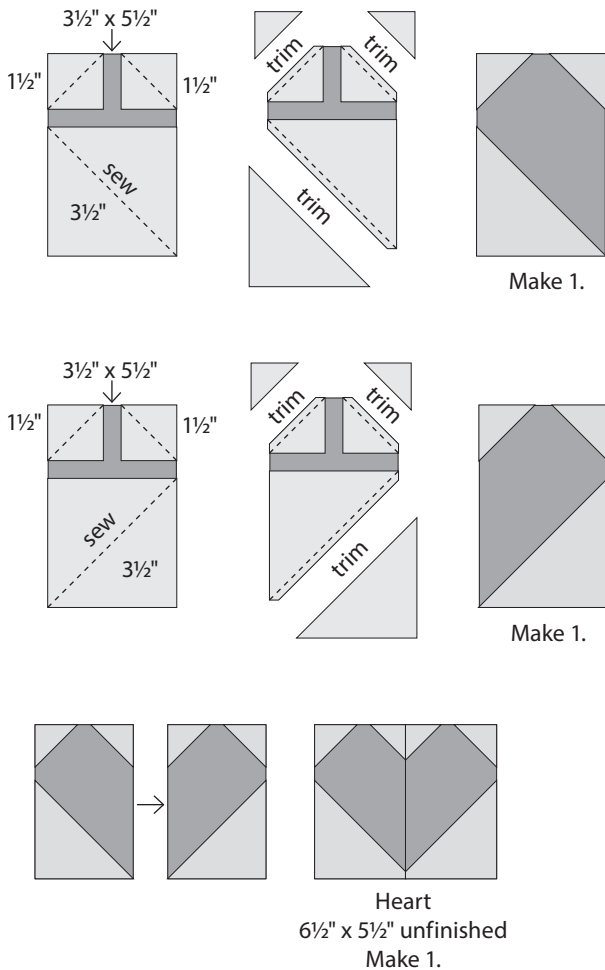

3 House assembly Assemble the heart house as shown. Use fusible web and a zig zag or blanket stitch to add the bird to the completed house block.

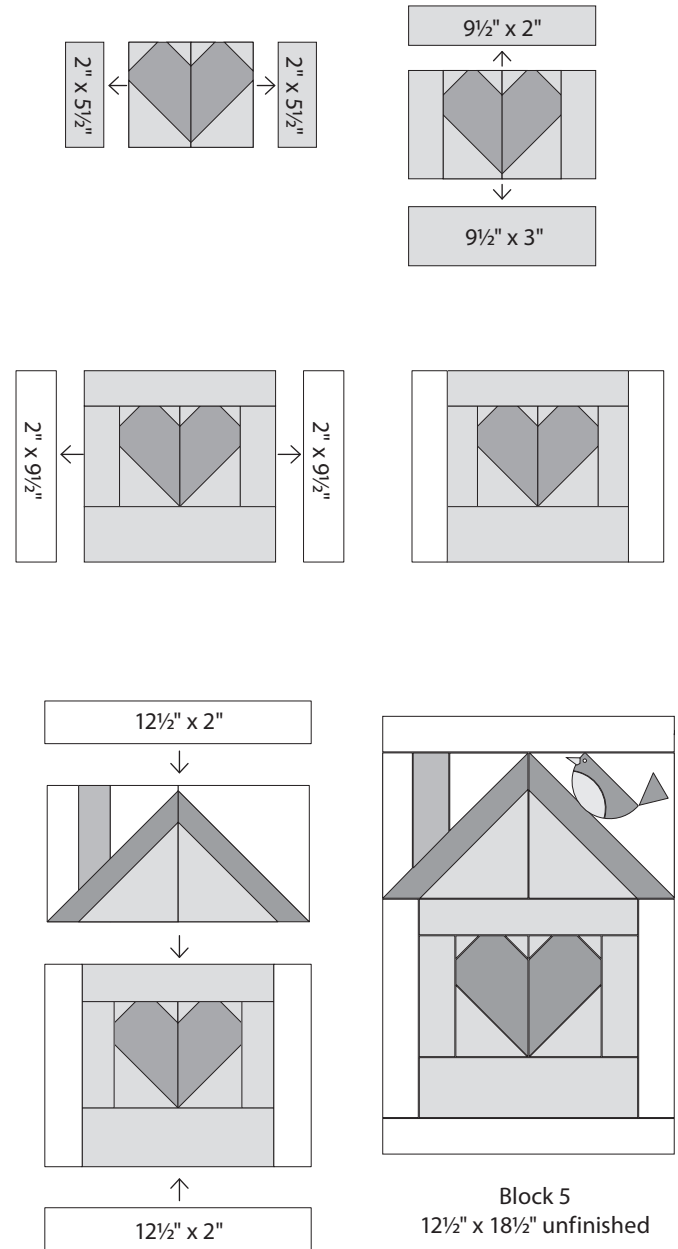

moda